

How to access the service portal of AKM and austro mechana

1 You know your login details

Go to www.akm-aume.at.

Click „LOGIN“ in the top right corner of the page. A box opens, enter your user name (“Benutzername”) and password (“Passwort”), then click Login.



2 You do not know your login details

2.1 You forgot your password

Go to www.akm-aume.at.

Click „LOGIN“ in the top right corner of the page. A new page opens, click “Benutzername oder Passwort vergessen?” (forgot user name or password?)

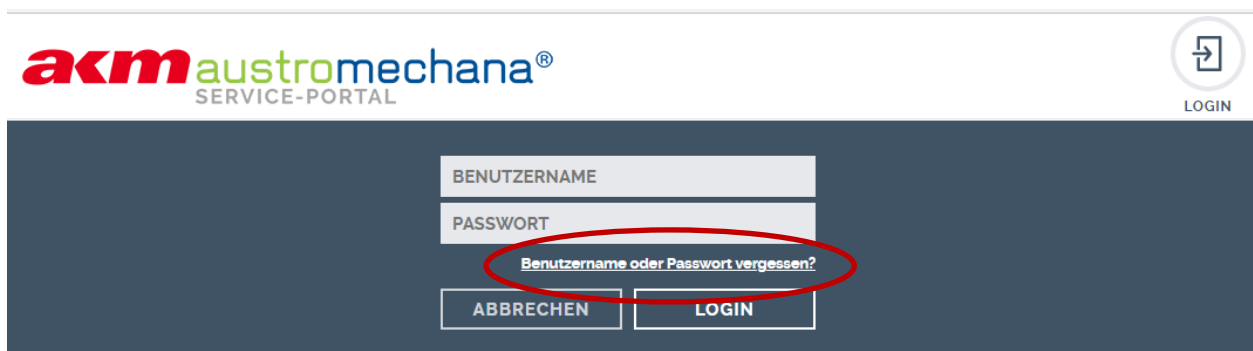

A new window opens, asking for your Username (Benutzername). Enter your username, confirm that you are not a robot (Ich bin kein Roboter) and click SENDEN (submit). If the user name is valid you will receive an e-mail to set a new password.

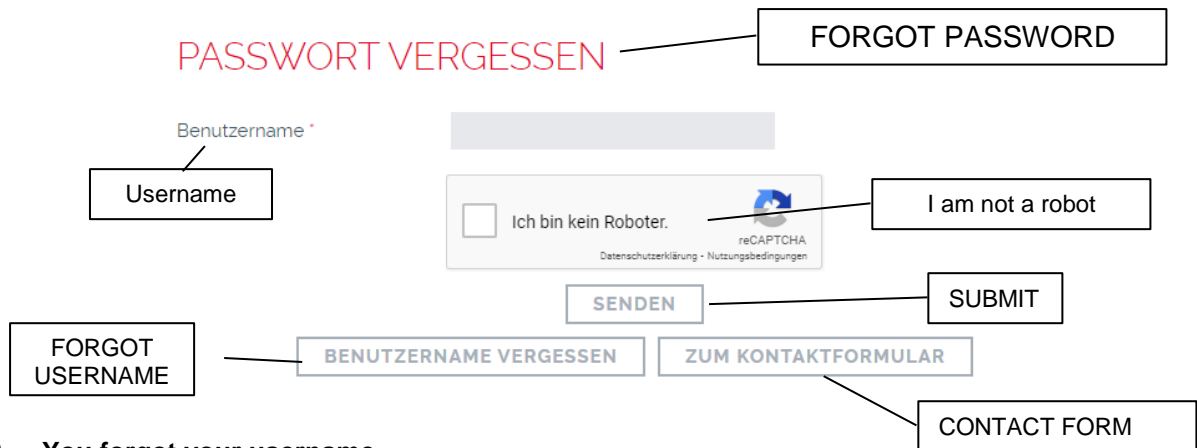

2.2 You forgot your username

Click Benutzername vergessen (Forgot username). A new page opens, enter your e-mail address, confirm that you are not a robot and click SENDEN (submit).



2.3 You forgot both username and password

Click ZUM KONTAKTFORMULAR (CONTACT FORM). A new page opens and you are asked to choose the role you require access for.

KONTAKTFORMULAR

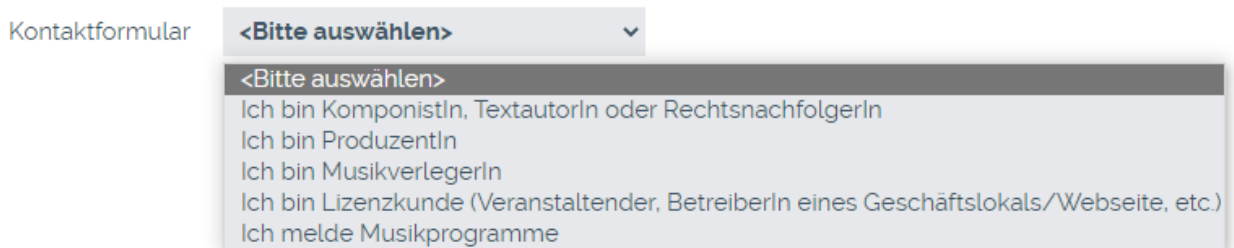

Ich bin KomponistIn, TextautorIn oder RechtsnachfolgerIn	I am composer, author or legal successor
Ich bin ProduzentIn	I am producer
Ich bin MusikverlegerIn	I am publisher
Ich bin Lizenzkunde (Veranstaltender, BetreiberIn eines Geschäftslokals, Website, etc.)	I am licensee (event organizer, owner of an outlet or website, etc.)
Ich melde Musikprogramme	I submit music programs

Depending on which role you chose a contact form appears. Fill in the required fields and submit the form by clicking on WEITER.

KONTAKTFORMULAR

Kontaktformular **Ich bin KomponistIn, TextautorIn** ▾

Bitte setzen Sie sich mit uns über das Formular in Kontakt.

(Bei Feldern mit * ist eine Eingabe erforderlich)

Kontaktformular

	E-Mail *	<input type="text"/>
First name	Vorname *	<input type="text"/>
Surname	Nachname *	<input type="text"/>
Date of birth	Geburtsdatum *	<input type="text"/> 

If the information you provided corresponds with the data in your profile you will get an automated mail with your user name and a link to set a new password. If it is not clearly identifiable your request will be forwarded for manual handling.